

# Hardt Ranch

413 Acres | Yancey, Tx | Medina County



Gruber Ranch Sales  
*Representing the Best of Texas*



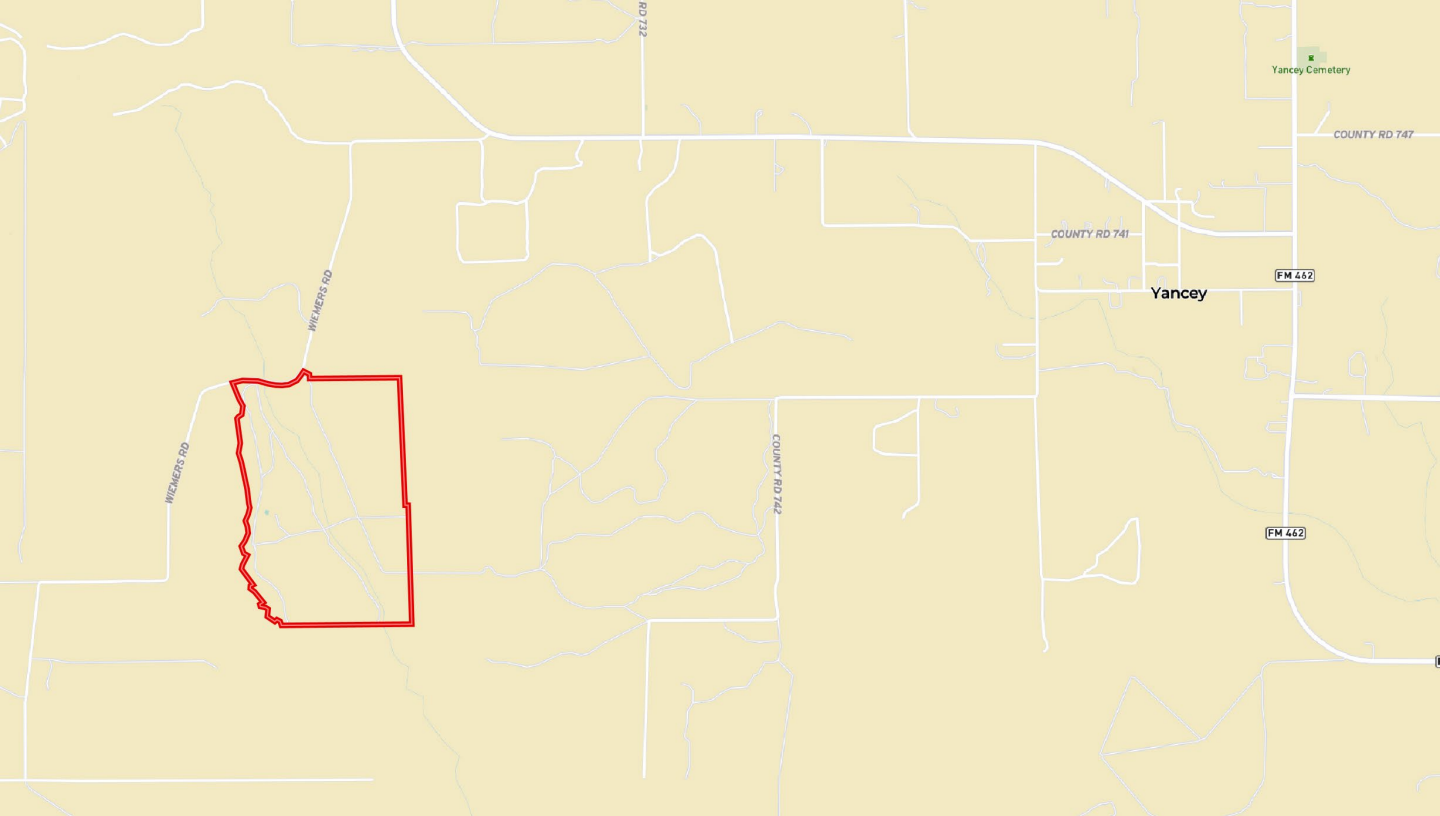

Located in Medina County 5 miles west of Yancey, 15 miles south of Hondo is this picturesque 413 +/- acre working/recreational ranch. This ranch offers two entrances on paved County Road 731.







- Gate
- Well
- Trough
- Fence
- Pond / Tank
- Boundary
- Stream, Intermittent
- River/Creek
- Water Body



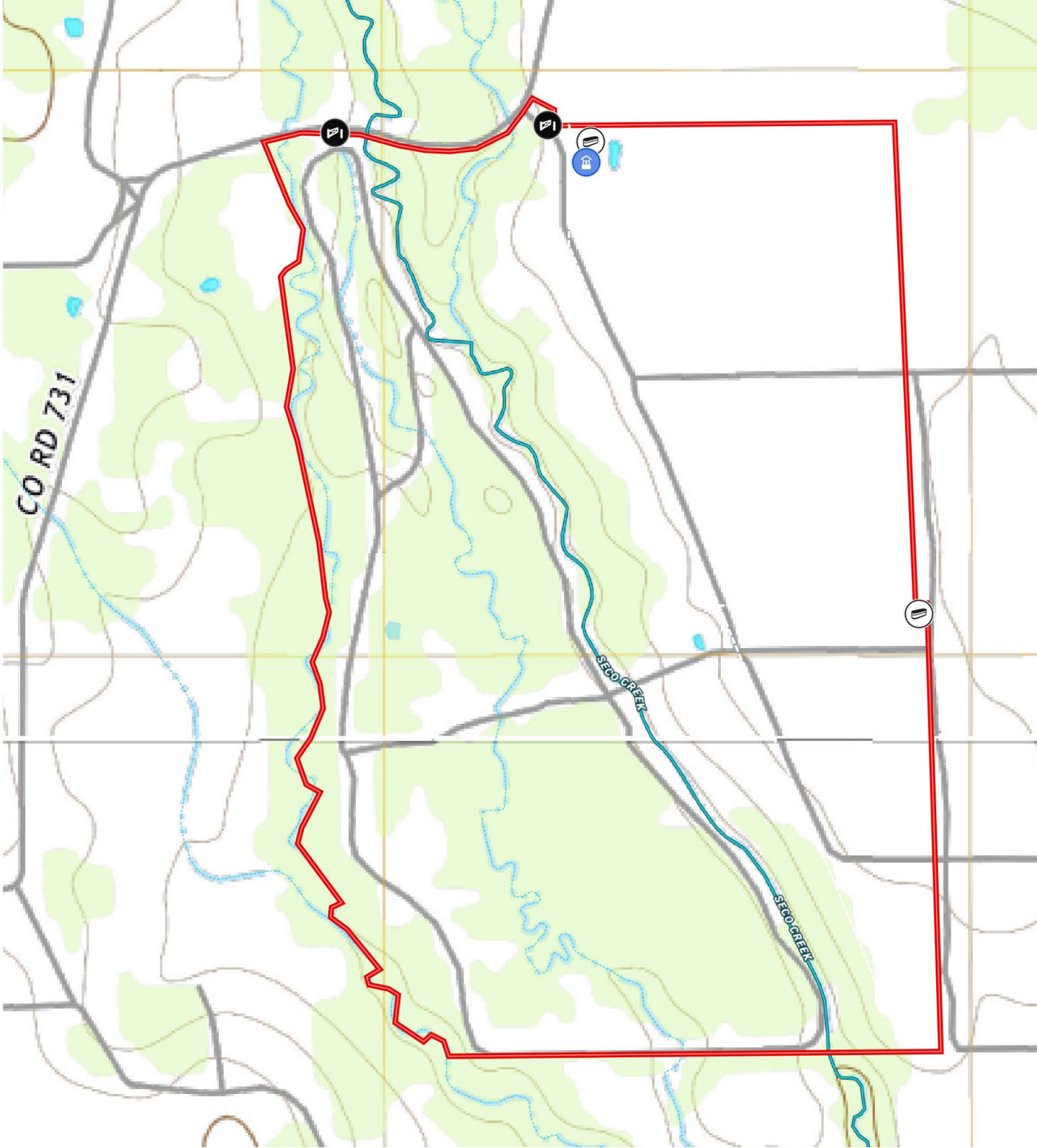

-  Gate
-  Well
-  Trough
-  Fence
-  Pond / Tank
-  Boundary
-  Stream, Intermittent
-  River/Creek
-  Water Body





This amazing 413-acre ranch has been in the same family for over 75 years and consists of 263 acres of dense, native wooded pasture with many gullies and ravines and approximately one mile of the Seco Creek running from north to south. The remainder of the property is regrowth mesquite and 150 acres of field or pastureland. This is an unbelievable hunting ranch with whitetail deer, feral hogs, turkey, dove, and quail being very abundant. Electricity and a shallow water well are on site as well as a Yancey Water Supply line. The Seco Creek, while causing considerable flood plain, adds to the beauty and uniqueness of this recreational property. The east portion of this property lies outside of the flood zone allowing for residential and agricultural opportunities. Minerals are negotiable. This property is a perfect multi-use ranch and can be viewed by appointment only.





























